

671

V.  
A.

14x49

Náamrechla

Banqueira do João de Deus

António dos Santos presb. of Greek

Universidade de Coimbra



Withdrawn

Michael Hewson

(MICHAEL HEWSON)

30/11/83.



# Index

Page	
1	Inscriptions in Magdalena Street
2	Casa dos Bicas
3	Triumphal Arch Beja
4	S <sup>t</sup> . Andrews Church. Beja
5	Door of the <del>St. Andrews</del> Church. Ibid.
6	S <sup>t</sup> . Peter's Front
7	Inscriptions found in Beja
8	Statue of the goddess Cybele
9	Inscription on a <del>stone</del> font. Uru
10	Arms of Beja. Inscription in the plaza. heads.
11	Church of the Misericordia
12	Roman Aqueduct. Sarcophagus
13	Oil press
14	an Oil mill
15	View of the place which contain the olives
16	View of the castle of Beja
17	Head of Augustus. head. Sarcophagus
18	Inscriptions & Arms found in Beja
19	Dagger sword. Thor. Amphora
20	Gothic Inscription well wrote
21	Inscription found in Beja
22	D. D. D.

Page	
23	Inscription. & Vase. found in Beja
24	Naumachia found in D <sup>o</sup>
25	Arabic. Inscriptions found at Evora
26	Byzantine Tower over aqueduct
27	Window over the Entrance to the church <sup>Fig. 1</sup>
28	Plan of S <sup>t</sup> . Francis Church Plan of casa dos Coos
29	Inscriptions found at Evora
30	Inscriptions & Vase found in Evora
31	Inscriptions. found - D <sup>o</sup>
32	Inscriptions by John. 3. & Philip 2 <sup>d</sup>
33	View of the Temple of Diana
34	Plan of the Temple of Diana Evora
35	View of aqueduct evora. Window & Gateway
36	View of casa dos Coos. Door entrance
37	Tomb of Feltonius. Evora
38	Church of Sombros. Evora
39	Church of the Jesuit Setuval
40	View of P. Jellal
41	Plan of Salt Potts. Setuval



D.A.

SV.

OFERTA DA BNIRL. (1984)  
270593

agrad

*[Faint handwritten text, possibly a name or address]*

*[Faint handwritten text, possibly a date or recipient information]*

Nos os dias, q' aqui estamos, pelos vossos esperamos

NATIONAL  
LIBRARY OF  
IRELAND.  
Joy Collection

NCB 1705737



*Casa dos Bicos at the Ribeira Velha Lisbon*



*[Faint, illegible handwritten text, possibly bleed-through from the reverse side of the page.]*



Part 1  
Height about 34.0

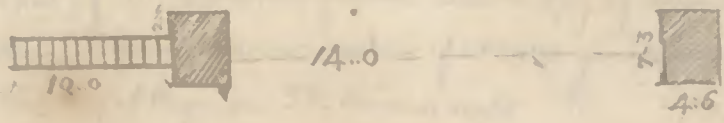

A Triumphal Arch at Beja of great antiquity



*Faint handwritten text, possibly a signature or a note, located at the bottom of the page.*





View of St. Andrews Church near the City of Biza built by King Alfonso in commemoration of a battle gained over the moors before the City of Biza on St. Andrews night

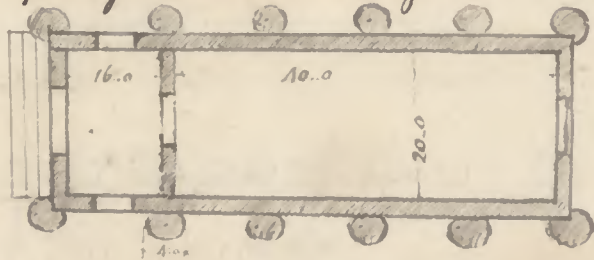

Plan of St. Andrews Church



View of the building from the top of the hill  
The building is situated on a hillside  
The drawing is a pencil sketch



View of the building  
The drawing is a pencil sketch



LOVVADO S<sup>E</sup>JA  
 OSANTISSIMO  
 SACRAMENTO  
 ANNO

AVIRGEM MARIA  
 FOI CONCEBIDA  
 SEM PECADO  
 ORIGINAL  
 DOMINI 11610

*Doorway to the principal Entrance  
 of the Church of the Conception in Beja*

*Inscriptions at A.B.*

<p><i>Lovado seja  o Santissimo  Sacramento</i></p>	<p><i>A Virgem Maria  Foi concebida  sem pecado  Original</i></p>
---	---



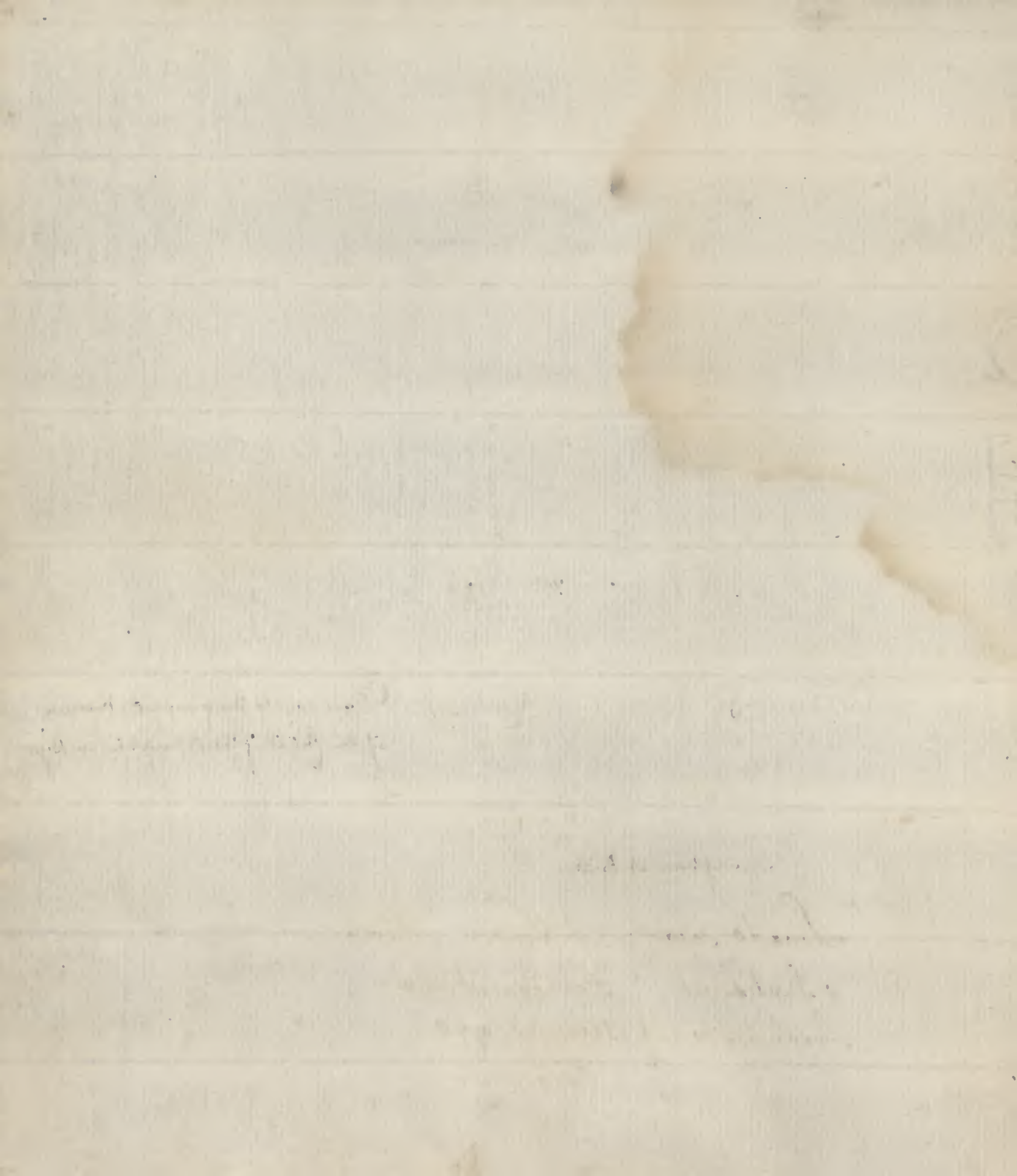

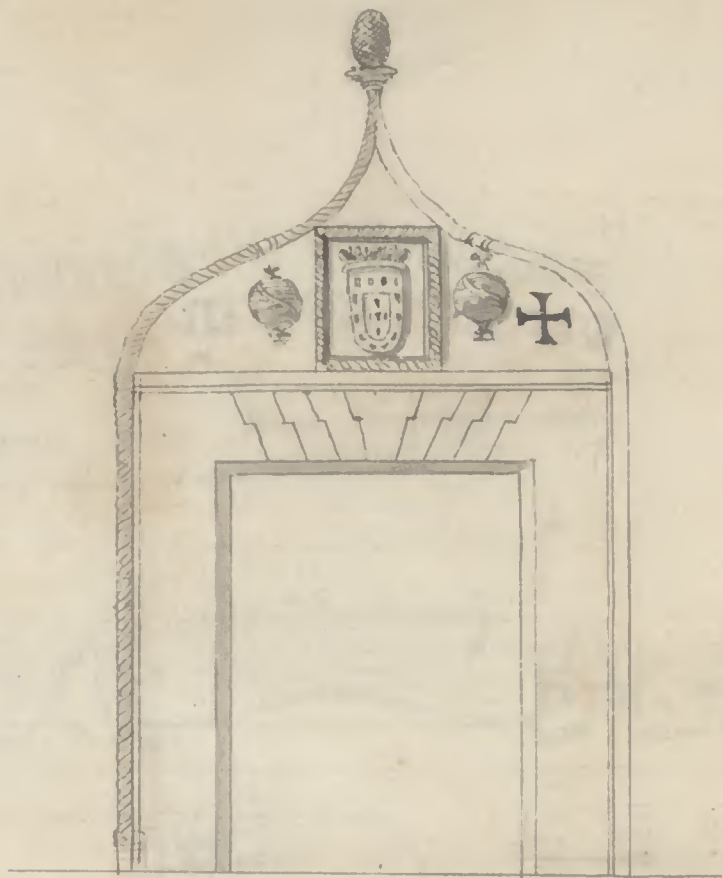

Door way to the Convent of the Conception Church. Mexico, built by  
 Prince Don Duarte and his wife Dona Isabella



Handwritten text, likely a description or title, written in a cursive script. The text is extremely faint and difficult to decipher, but appears to be a single line of writing.



MISEREERE ME DEUS  
SECUNDUM MAGNAM  
MISERICORDIAM TUAM

The first Verse of  
the 50 Psalm

Misereere . mi . Deus . Secundum . Ma-  
gnam . Misericordiam . tuam

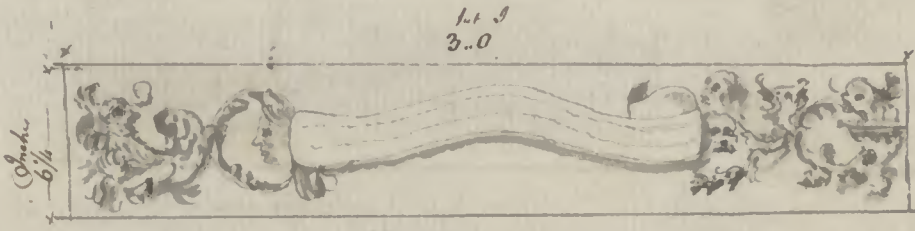

DE POSI  
TIO PAV  
LIE AMV  
LV S DEI  
VIX SIT  
ANNOS LXX  
I VNO REX VI  
EVIT N PAC  
E D III DV S M  
ARTASER  
A R XXX II

231

"Hic Jacet R. C. in expectatione  
diei Rapturæ. Qualis erit, dies iste  
indicabit"

"Here lies R. C. in expectation of the  
last day, what sort of man <sup>he was,</sup> that day will discover"

The Spectator introduces the above epitaph in one of  
his Papers on which he then expresses himself  
"The thought of it is serious, and in my  
opinion the finest that I ever met with upon  
this occasion. It is usual, after having told us  
the name of the person who lies interred, to launch  
out into his praises, This Epitaph lacks quite a  
contrary turn, having been made by the person  
himself some time before his death. See Spect. Vol 7, p 518  
See Description R. C. p 35

EDMUND SPENCER  
DEPT. OF AGRICULTURE

A

M. A. M.  
 MERCATOR  
 ANN XXXII  
 VXOR MARIT  
 MERENII POSVVO  
 H. S. E. S. F. T. L.



This Cylinder is shaped to imitate  
 a barrel ~~being~~ formed of Solid  
 Stone, bearing the Inscription at  
 the left hand on the side of the barrel  
 marked A. in the possession of the  
 Bishop of Bija

B



This vase found on the side  
 of an old Stone that formerly had  
 an Inscription found in the city of  
 Bija

piece of a col.<sup>m</sup> found in the City of Mestola

~~The ornaments which cover this column discover it to have  
 been in a Temple dedicated to Bacchus. the manner  
 of placing each piece of the column on the other is different  
 from any other I ever saw. B is however the end of the next  
 piece must have been spherical like the Stones in the Giants  
 Causeway~~

This piece of a col. found in the City of  
 Mestola appears by the ornaments to have  
 been used as a font in the Temple dedicated  
 to Bacchus. the top B being hollowed out



NATIONAL  
LIBRARY OF  
IRELAND.  
Collector



Church of the Misericordia. Oya. the front has a neat simple  
 appearance. every Church in Portugal of this name are intended for charitable  
 purposes. as the care of Hospitals. Burying the dead. taking in foundlings.  
 &c. &c. supported by a Society of the filerms who contribute a certain sum  
 annually to this purpose.



Handwritten text, likely bleed-through from the reverse side of the page. The text is illegible due to fading and is oriented upside down relative to the page's orientation.





Roman Aqueduct the remains of which may be seen at Deja, it extends 3 leagues  
 the arch and sides are built of small Round Stones promiscuously thrown together  
 which are become cemented together like one solid Stone by the strength of the mortar  
 or Cement which unites them.



Sarcophagus ~~found~~ found in the village of Vienna near Deja being the  
 coffin of the Gothic King Musa.



Manuscript text, likely bleed-through from the reverse side of the page. The text is written in a cursive script and is mostly illegible due to fading and bleed-through.

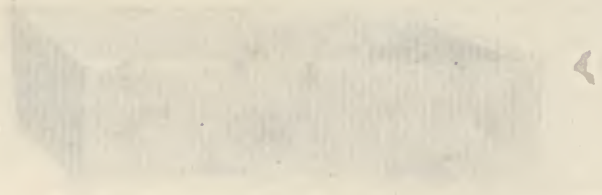

Manuscript text, likely bleed-through from the reverse side of the page. The text is written in a cursive script and is mostly illegible due to fading and bleed-through.

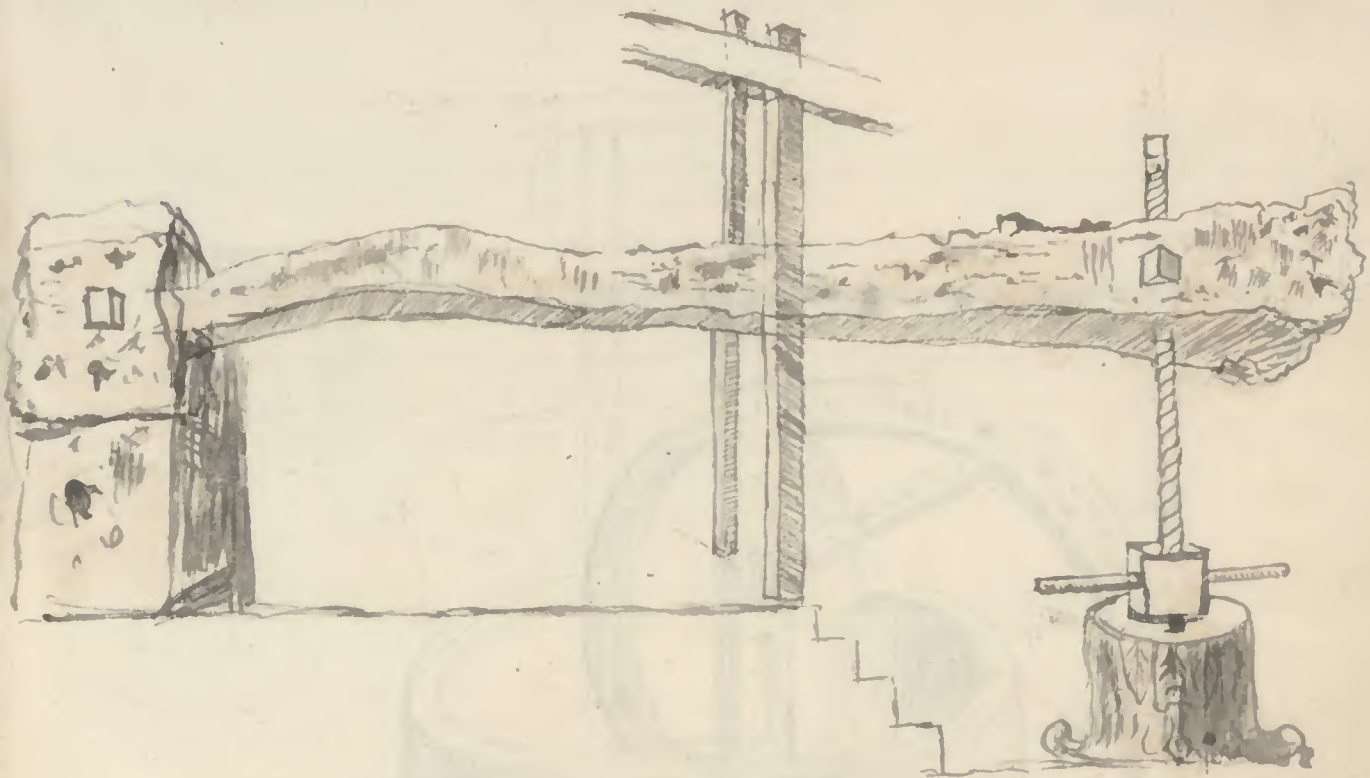

© An oil press

*Faint, illegible handwritten text, possibly describing the mechanism or its use.*



Handwritten text, possibly a signature or name, written in cursive script.



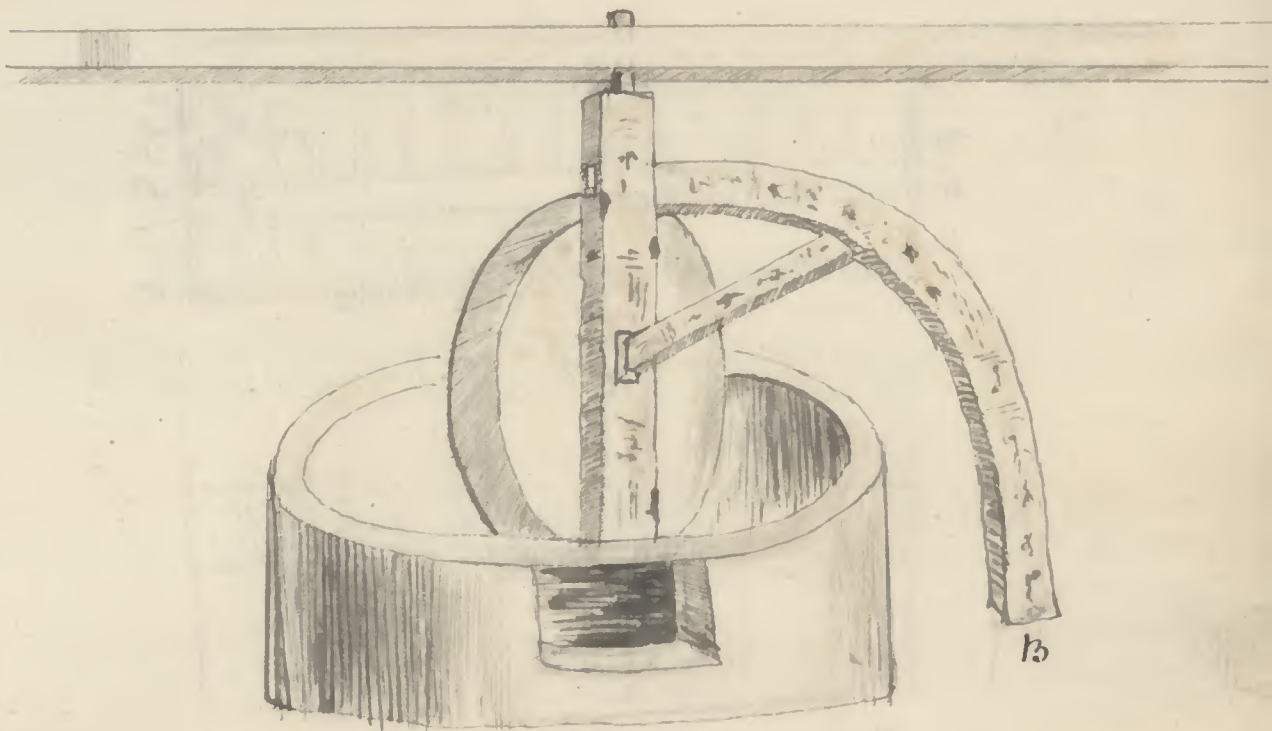

An oil press used by the People of this province for the first pressing of the olives. it is turned round by means of a wheel attached to the Lever B.

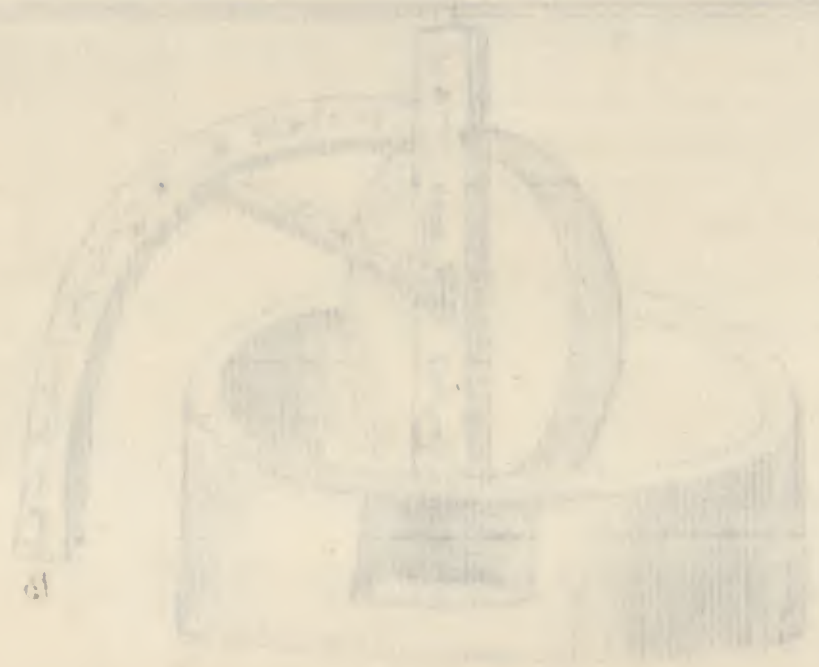

It is a part of the top of the frame for the  
first part of the work, it is a part of the frame of work  
which is shown in the drawing.

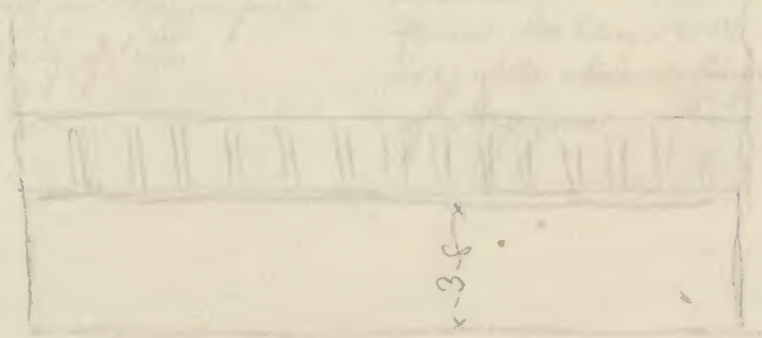





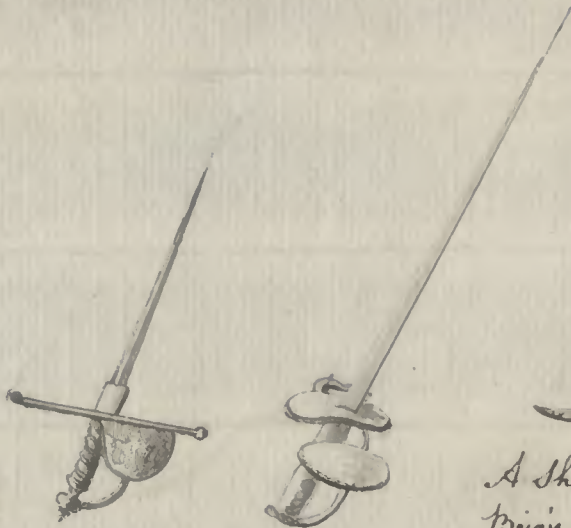

A Sword and Dagger found  
in the City of Byz.



A Shoe in the Bishop's of  
Byz's Museum upwards of  
a Hundred years old elegantly  
floured. It belonged to the  
Lady of the *Missa de fance*  
of *Messijana*

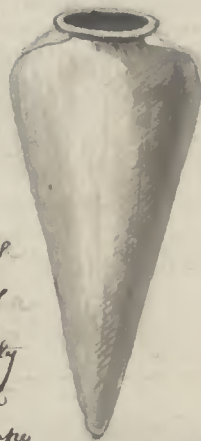

An ~~amphora~~ Amphora  
discovered underground  
in the City of *Messijana*  
in the possession of the  
Bishop of Byz.

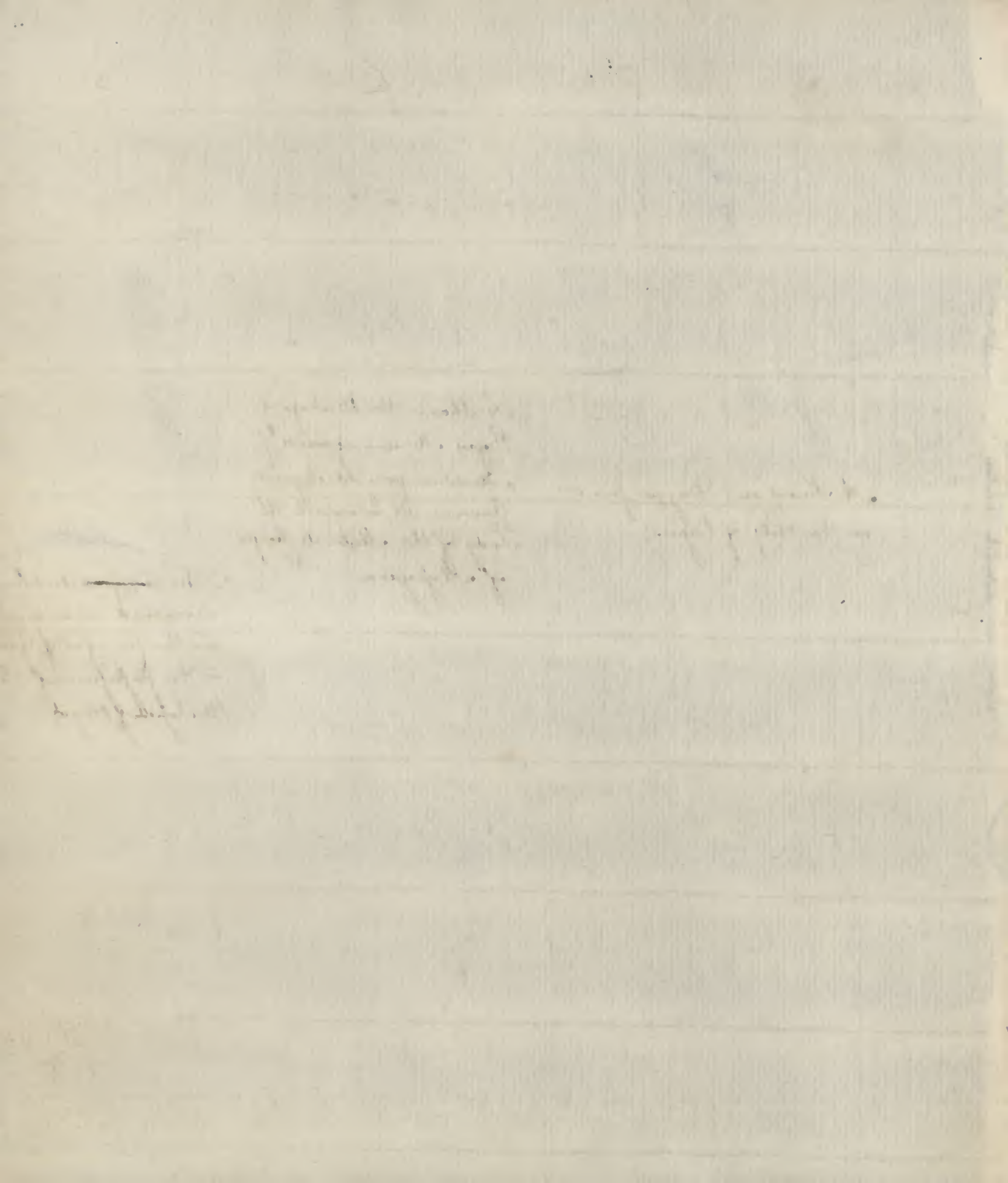

In the Bishop of Bija's Palace

espiualas merçuo  
 aze raduã o quactuo  
 oual jaz rezultado na  
 cepeira uo rã se  
 aze (Xadã ualua

De... 10

...  
...  
...  
...  
...



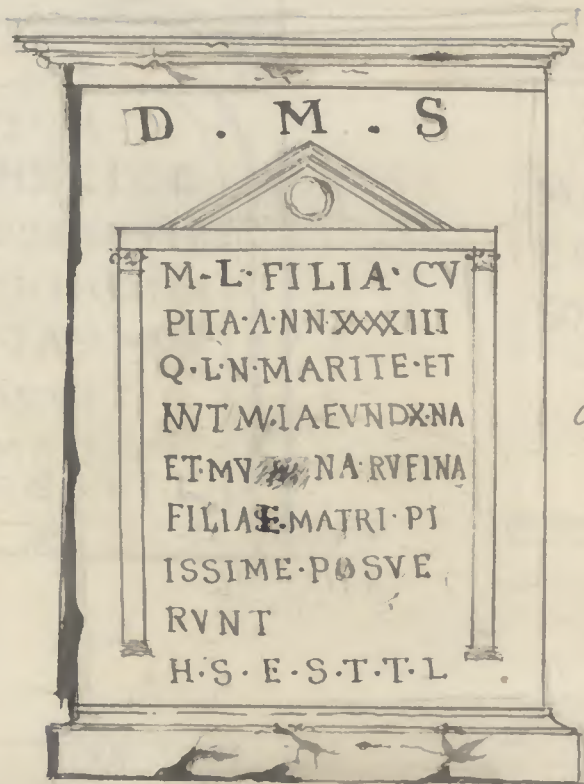

*On the Bishop of Rojas Palace*



NATIONAL  
LIBRARY OF  
IRELAND.  
For Collections

22nd July 1917

*In the Possession of the Bishop of Baya*

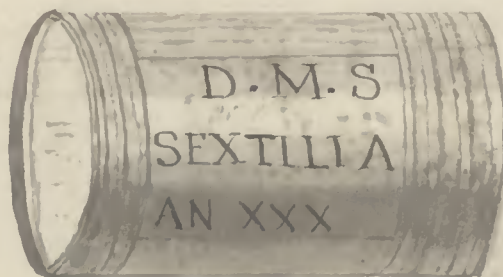
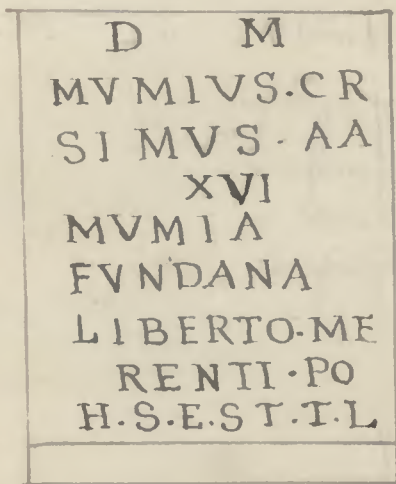
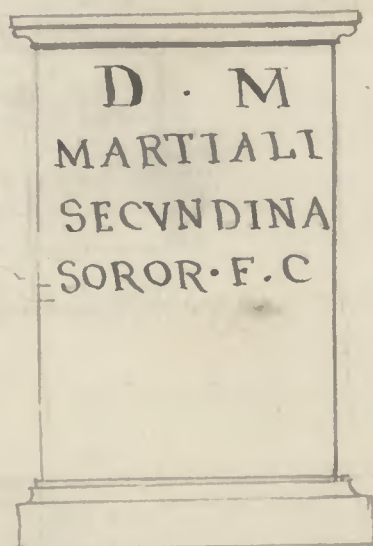
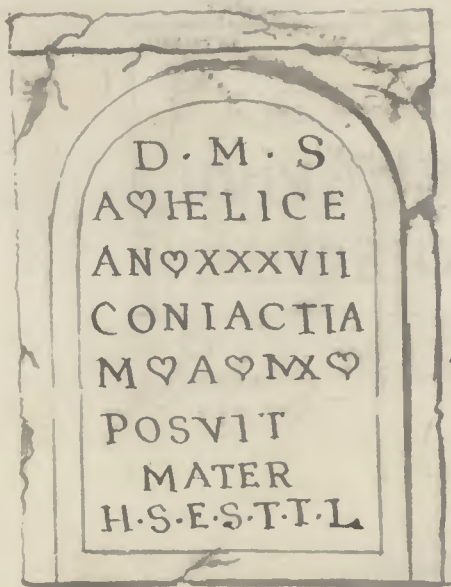

*of Solid Stone*

*Handwritten text at the top of the page, possibly a title or reference number.*



*Handwritten text below the cylindrical stamp, possibly a signature or date.*

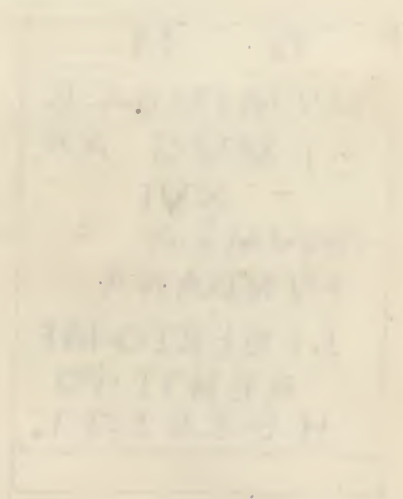



*On the possession of the Bishops of Bija*

PRÆTORIVM CAVSAR  
 HVIVS VRBIS RE<sup>F</sup>LECT  
 IMPERIO PHILIPPI

*Probably this was Mark Julius Philippus*

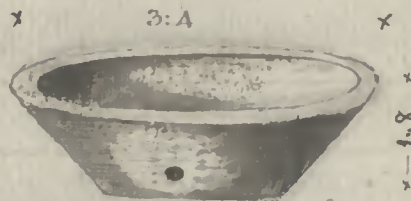

*A Vase or Basin ~~to put~~ found under ground in the City  
 of Bija made of a composition of lime and brick dust it is as firm  
 as a piece of Marble and not injured in the least it was situate near  
 an altar under a small Stone Chamber ~~to receive~~ the blood of the Victims  
 to Sacrificed there.*

Of the History of the Kingdom of Spain

IMPERIO PHILIPPO  
REXIS VARIIS RE  
PRAETORIANI CAESAR

Proprietor of the ... ..



~~...~~  
... ..  
... ..  
... ..  
... ..

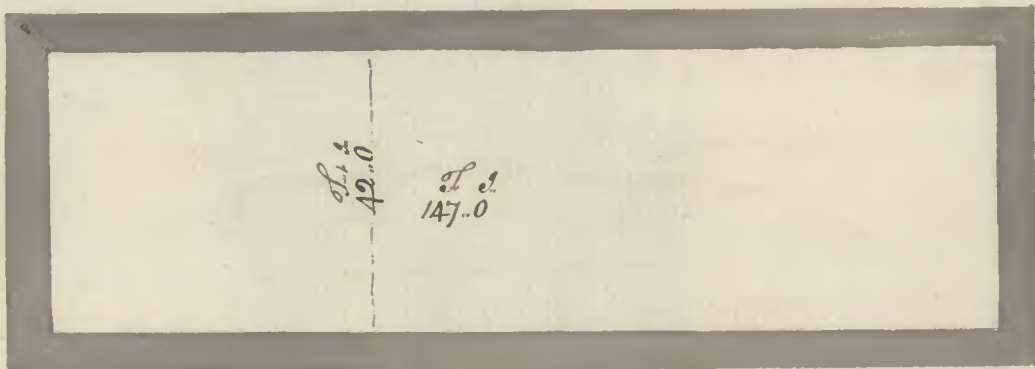

Plan of a Naumachia near the City of Beja. The present depth is about 6 feet below the level of the surface. The sides are cased with a cement that is as hard as a stone made of a composition of Brick pounded. Small gravel and quick lime mixed together.

Evora



*[Faint, illegible handwritten text]*

NATIONAL  
LIBRARY OF  
IRELAND  
45, QUEEN'S ROAD

*[Faint red stamp or mark]*



feet 3  
 12.6 Diameter  
 beside the remains of  
 the Forum

An ancient Peristyle Tower built on the Roman aqueduct at Cosa. The entire is of brick  
 plastered, with a kind of cement the colour of free stone and equally hard. It has a beautiful rich  
 appearance and in tolerable preservation considering it was built before Christianity. Survey of  
 aqueduct. page 35



90

	66	22	20
	<u>5</u>	<u>5</u>	<u>5</u>
1792		100	
9			



10  
 20  
 30  
 40  
 50  
 60  
 70  
 80  
 90  
 100

The drawing is a very faint pencil sketch of a classical building facade, possibly a temple or church, with a pediment and columns. The drawing is extremely light and occupies the central portion of the page.

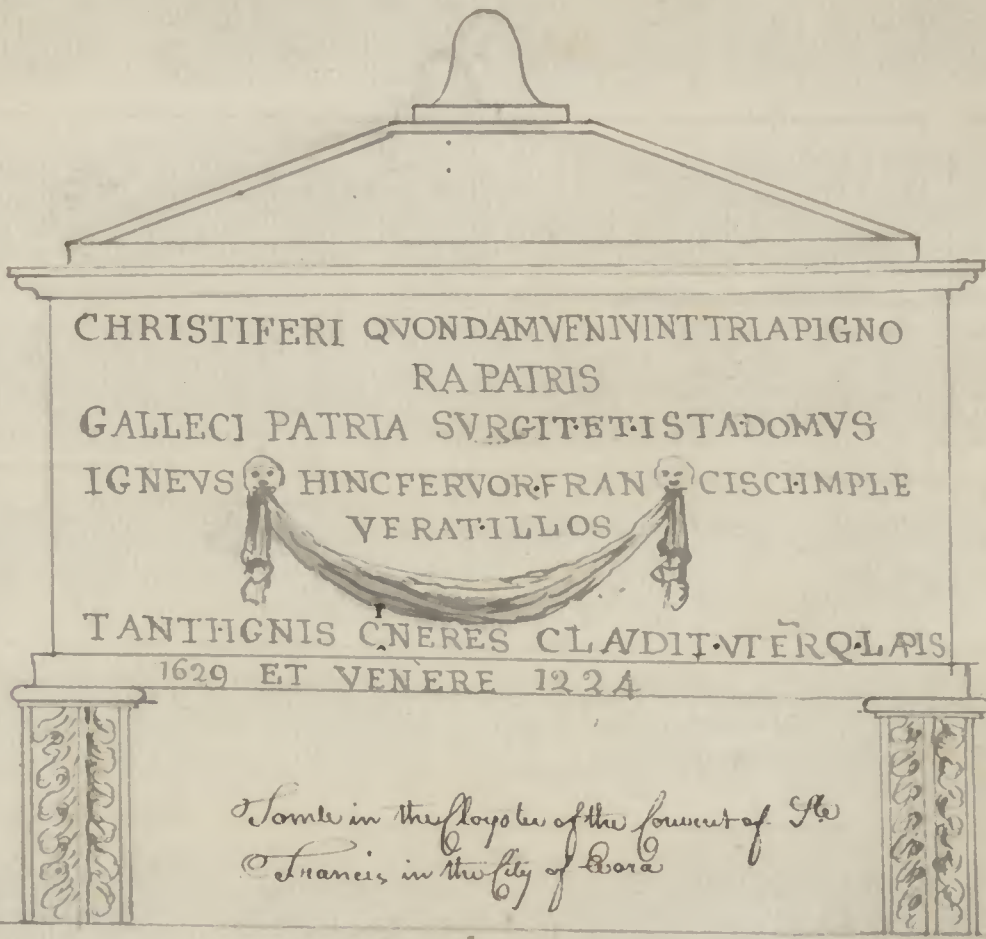

*Tombe in the foyote of the fount of St  
 Francis in the city of Bora*

*A Window over the West Entrance  
 of the fount of St. Francis Bora*

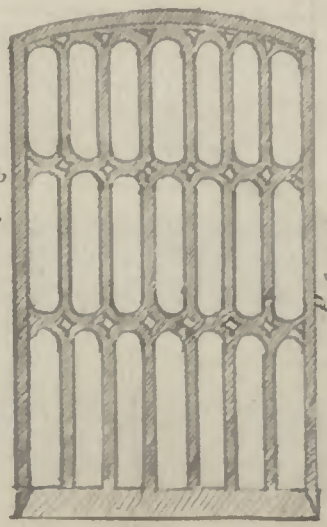

*14 high*



UNIVERSITY OF TORONTO LIBRARY  
130 St. George Street  
Toronto, Ontario M5S 1A5  
Canada

A pencil sketch of a classical building facade, showing a pediment supported by two columns. The drawing is very faint and appears to be a preliminary study or a light pencil sketch.

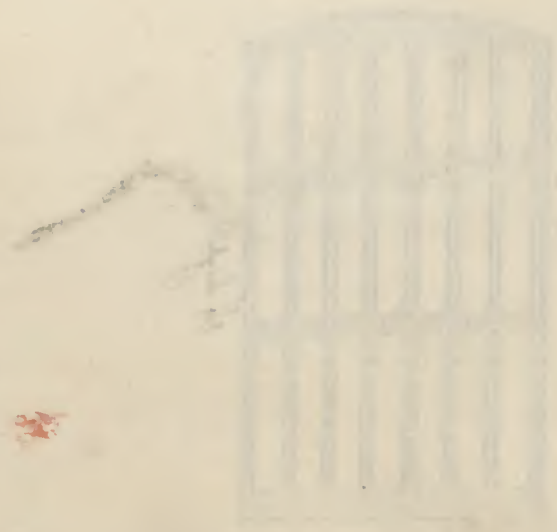

A faint pencil sketch of a vertical architectural element, possibly a column or a window frame. The drawing is very light and appears to be a preliminary study.

22

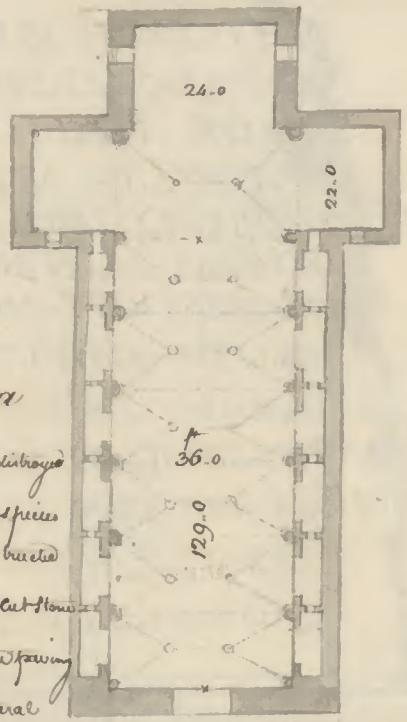

*Church of St. Francis Evora*

re-built by King Emmanuel after being destroyed by an Earthquake, the Architecture is a species of Gothic. The vault of the roof is well furnished with Brick the ribbing or skeleton is of Cut Stone. The height of the center of the vault from the paving of the Church is 98 feet, there are 6 Lateral Chapels on each side with a communication from one to the other, the Cross aisle as well as the Chancel are round like a Star, the whole inside has a free disengaged appearance and is considered with respect to the vaulting the best built temple in Portugal

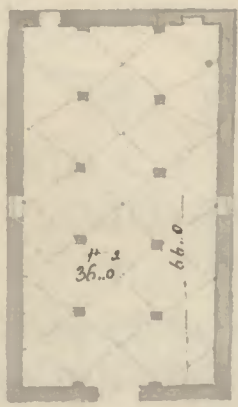

*Casa dos Coos or House of bones near the Chapter room of the Franciscan Convent Evora See the view in page 36*

NATIONAL  
LIBRARY OF  
IRELAND.  
Joy Collection

10. 31. 0



76 &amp; 221

L. VOCONIO. L. I. F.  
 QVIR. PAVLILLO. AED. Q.  
 ILVIR. VI. FLAM. ROM.  
 DIVORVM. ET. AVGG.  
 P. RAEF. COH. I. LVSIT. ET. CO.  
 VETTONVM. L. EG. III. ITAL.  
 OBCAVSAS. VTIU. TAESQ. PVB.  
 CAS. APVT. ORDIN. AMPLISS.  
 FIDELITER. ET. CONSTANTER.  
 DEFENSAS. LEGATIONE. QVA. GR.  
 TVITA. ROMAE. PROR. P. SV. FVN. EST.  
 LIB. IVL. EBORA  
 PVBLICE. IN. FORO.

P. STAINS  
 P. IIB  
 MERIDIA  
 NVS. H. S. E

D M S

C. ANONIO. C. F. FLA  
 VINO. VI. VIRO IVN  
 HAST. LEG. I. AVG. TORQ.  
 AVR. ET. AN. DVPL. OB. VIRT.  
 DONATO. IVN. VERECVN  
 DA. FLAM. PERP. MVN. EBOR  
 MATER. F. C.

p. 73 &amp; 219

MEMORIA  
PUB  
1717

MEMORIA  
PUB  
1717

MEMORIA  
PUB  
1717



*Vase found before the Prison in  
Evria*

CILIO . Q . F .  
 VOLVS AEF  
 COH . G . R . SEX  
 PROVOC . VICTORI .  
 DON . DONATO . AB .  
 IMPER II . HAST .  
 PYR . III . VEXIL  
 CIVIC . I . MVR  
 III . OBSID . NIB  
 HIS . IN . RES . S . FVNC  
 EBORENS . CIVI . OPT  
 MERITA . EIVS . IN  
 MVNIC . MARMOR  
 BASI . AENE D . D

MANILIAM F  
 MAXVMA ANXII  
 H . S . E . ST . TL .  
 CVIBI VSTANCI  
 NVSCOGNATAE  
 SVAE F C

LARIB . PRO .  
 SALTE ET IN COLV .  
 MITATE DOMVVS  
 Q . SERTORI .  
 COMETA B . LVDS  
 ET EPVEMVICNEIS  
 IVN . DONACE . DO  
 MESTICA EIVS ET  
 Q . SERTOR HERMES  
 Q . SERTOR CEPALO  
 Q . SERTOR AEROS  
 LIBERTEI

48 223

found

665

47 4200

found

*Handwritten text, possibly a signature or title, located in the upper left corner.*



PLATE I  
MATERIALS  
FOR THE  
CONSTRUCTION  
OF THE  
BUILDING

PLATE II  
SECTIONAL  
VIEW OF THE  
BUILDING  
SHOWING  
THE  
INTERNAL  
STRUCTURE  
AND  
THE  
POSITION  
OF THE  
VASE

PLATE III  
SECTIONAL  
VIEW OF THE  
BUILDING  
SHOWING  
THE  
INTERNAL  
STRUCTURE  
AND  
THE  
POSITION  
OF THE  
VASE

page 61  
211

C. MINICIUS. C. F  
 LEM. IVBATVS  
 LEG. X. GEM. QVEM  
 CONTRA. VIRIAT.  
 VOLNERIB. SOPIT.  
 TVMIMP. CLAVD.  
 VNIMA. PROMOR  
 TVODERELIQVIT.  
 EBVR. LITIS. VSI  
 TANI. OPERA. SERV  
 RARI. IVSSVS  
 PAVCOS. SVPERV. DI  
 ES. MAESTV. OBIT  
 QVIA. BENE MER  
 GRAT. NON RETV

*fructu*

DIVO IVLIO  
 LIB. IVL. EBORA  
 OBILEVS INMVN  
 E. MVN. LBERALTA  
 TEM. EX. D. D. D  
 QVOIVS. DED. CATO  
 NE. VENER. GEN. E  
 RIC. DONVM. MA  
 TRONAE. CESTVM  
 TVLERVNT

I · O · M

OBPVLSOSA. Q. SERTOR  
 METEL. ADQ. POMPE IVN  
 DONACE. CORONA. ET. S CEP  
 T. REX. ARG. MVNVS. ADTVLIT  
 FLAMIN. PHIALA. CAELATAM  
 HIERODVLIS. COENA. M. D. D

48



1910  
DISTRICT OF COLUMBIA  
MAY 10 1910  
OFFICE OF THE  
COMMISSIONER OF  
LAND OFFICES  
WASHINGTON, D. C.

1910  
DISTRICT OF COLUMBIA  
MAY 10 1910  
OFFICE OF THE  
COMMISSIONER OF  
LAND OFFICES  
WASHINGTON, D. C.

1910  
DISTRICT OF COLUMBIA  
MAY 10 1910  
OFFICE OF THE  
COMMISSIONER OF  
LAND OFFICES  
WASHINGTON, D. C.

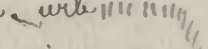
2. Sertorio ~~unus~~ ~~in~~ ~~re~~ ~~publica~~ ~~et~~ ~~in~~ ~~re~~ ~~publica~~ ~~et~~ ~~in~~ ~~re~~ ~~publica~~  
Honorem. nominis. sui. et. cohort. fort.  
Eborensium municip. vet. emer. virtutis. ergo  
Don. Don. bello. Celtiberico. deque. manubiis  
In publico. munice. eius. utilitatem. urb.   
moenivit. eoque. aquam. diverseis. ~~in~~ duct. ~~et~~  
unum. collectis. fontib. perducendam curavit.

Philip II aquam a. q. Sertorio ab agris  
olim Divonum ~~une~~ odior perducta  
et Joanne 3 restitutam regi et pie  
tatis Haeres munificencia regia conser  
vandam curavit beneficis beneficis  
poni Statuit cippis Eborens antiquam  
Nobilitatem attestantibus. Forum  
Illustrat anno dom 1605

Joannes III Lusitan. in India et in Africa  
Celeberrimam aquam argenteam ductum a. q.  
Sertorio an 75 ante d. Christum natum  
Extractum Barbarie. et antiquitate funde  
tus demolitum nova forma Liberali impen  
sa maiori aquarum copia adiecta XVIII mil  
pass ductu vorus p. p. in urbem reduxit  
Ann Salutis MDXXII

Strange

How fatal are the Transmutation of time, this venerable ruin  
that was formerly the Temple of the great Goddess Diana and the  
works of a powerful Hero is now converted <sup>abandoned</sup> into a most horrible  
composition

Evora

Evora is a very ancient City, encircled ~~at equal by a Circle of D.~~ equal  
I have seen few places that has more fine appearance  
Chain of small Hills, it abounds with the Reliques of the  
Successive Inhabitants; ~~its~~ its fortification ~~is~~ decaying with  
Age and Shattered by the Convulsions of time, Moorish walls  
& fortifications dismantled towers and ruins of every form

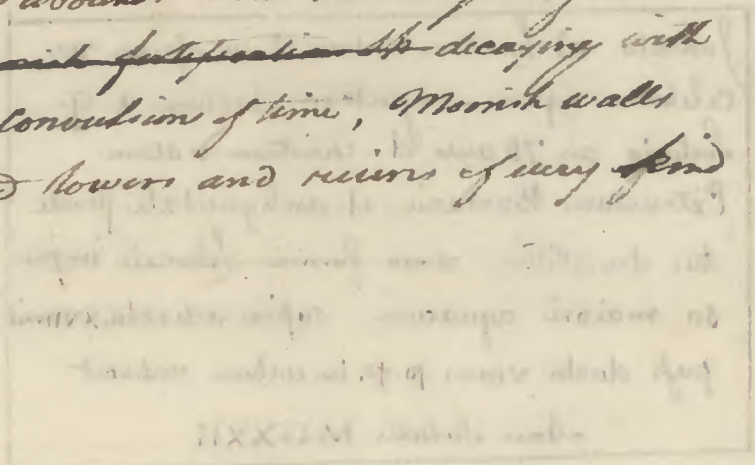



*View of the most stamites at Cosa formerly the Temple of Diana*

Evora is one of those scenes where the <sup>Gallant</sup> ~~admiral~~ ~~Antinous~~ ~~nope~~  
some glory



NATIONAL  
LIBRARY OF  
IRELAND  
Dublin



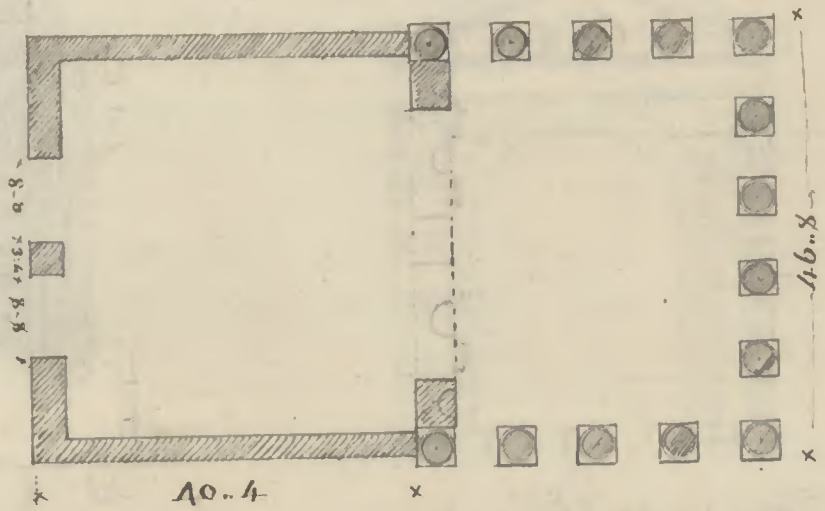

Plan of the Temple of Viana

Columns <sup>9</sup> 3.4 Diam<sup>s</sup> fluted  
 Base — 20 high  
 flutes — 6 1/2 broad semicircular  
 Corinthian order  
 Intercolumniation <sup>9</sup> 8.8 from center to center  
 3.4

This Temple probably was built by Victorians it looks to be in the style of the Roman Temples well proportioned and the Capitals well cut, the flutes are rather rustic for so delicate an order as the Corinthians, it is singular to have but five columns in the return. I think it must have been at the style each front finished with its proper Entablature instead of that rude Battlement which is on it at present which appears to be moorish as well as the part adjoining to it, at present it is converted to a most Shameless See view in last page



Plan of the  
 building of the  
 ...  
 ...  
 ...  
 ...  
 ...

The building is a rectangular structure with a central courtyard. The walls are thick and the roof is flat. The building is surrounded by a low wall. The plan shows the layout of the building and the courtyard. The building is located in the center of the site. The courtyard is a square area in the center of the building. The building is made of brick and has a simple design. The plan shows the layout of the building and the courtyard. The building is located in the center of the site. The courtyard is a square area in the center of the building. The building is made of brick and has a simple design.



15.0

Windows in the front of the Cathedral  
Church at Cora



An ancient gateway at Cora



View of a Roman aqueduct  
at Cora built by Sertorius

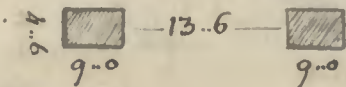



*Handwritten note in cursive script, partially illegible.*

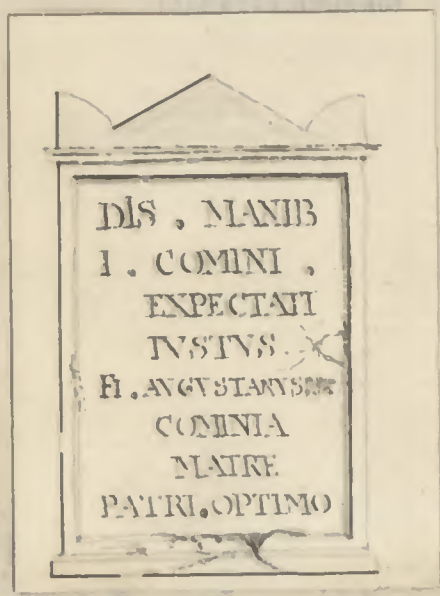

DIS, MANIB  
I. COMINI,  
EXPECTATI  
INSTVS.  
H. ANGVSTANVS  
COMINIA  
MARE  
PATRI. OPTIMO

NATIONAL  
LIBRARY OF  
IRELAND.  
Acq. Collection

*Faint handwritten notes at the bottom right of the page.*





Caxa dos Osos. in the Franciscan convent Evora. the Pillasters are lined with Human Skulls set in a hard cement. the walls are likewise covered with Skulls and Bones the entire presents a frightful spectacle. it was built in 1224. see the Plan page 28.

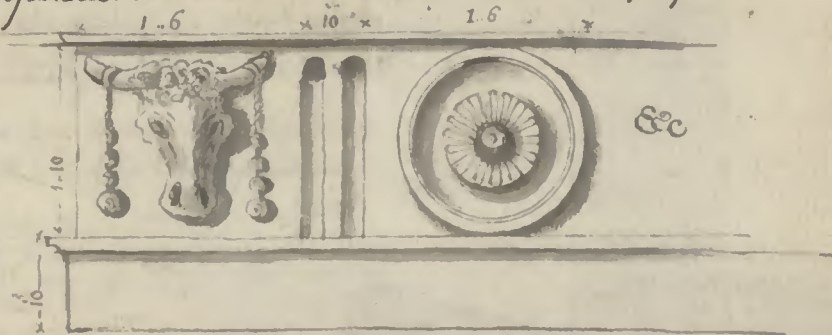

An ancient Doric Triglyph & Architrave in the walls of the praça at Evora



Ym or low for your return - 1/2 the other



I am for this in the first instance, because the architect has done well to show  
the plan and elevation, and the walls are thick and convenient. The plan shows the  
foundations of the building, and the walls are 2 feet thick. See the plan page 22.

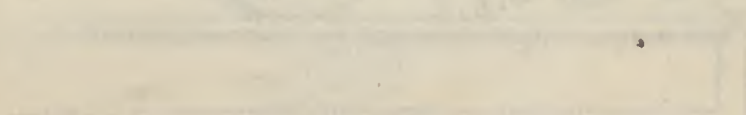

at home  
at home

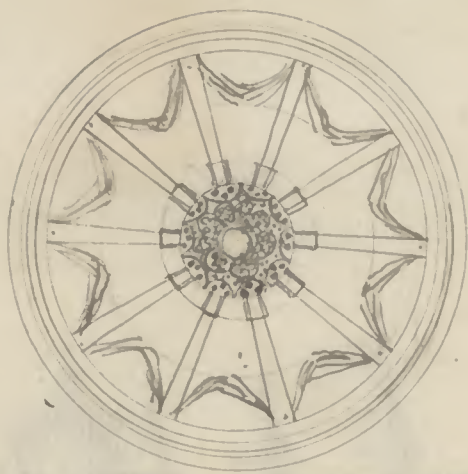

Window in the triforium of the  
Cathedral Church at Evora. about 10. Diam.<sup>r</sup>

View of a Roman Tower near  
St. John's Church Evora built by  
Sextorius, there are extensive vaults  
at the foot of it. which ~~probably~~  
probably were places of confinement,  
there is a Modern Stair case built  
within to go up to the top which  
commands an extensive view of the  
City & Country about —

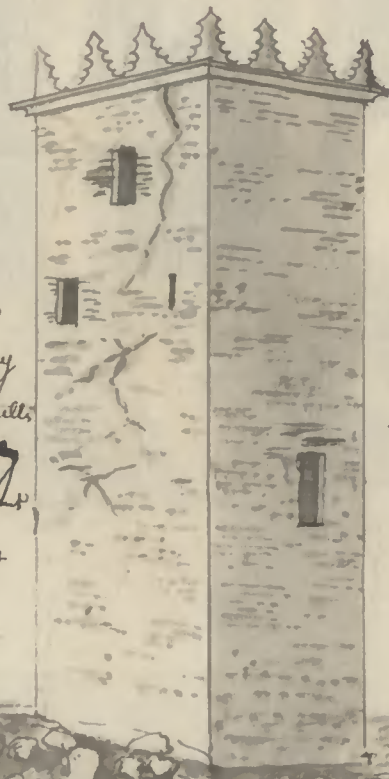

Handwritten text, possibly a title or header, located in the upper left corner.



Main body of handwritten text, appearing as several lines of cursive script in the lower right area.

Additional handwritten text or a signature located at the bottom of the page.



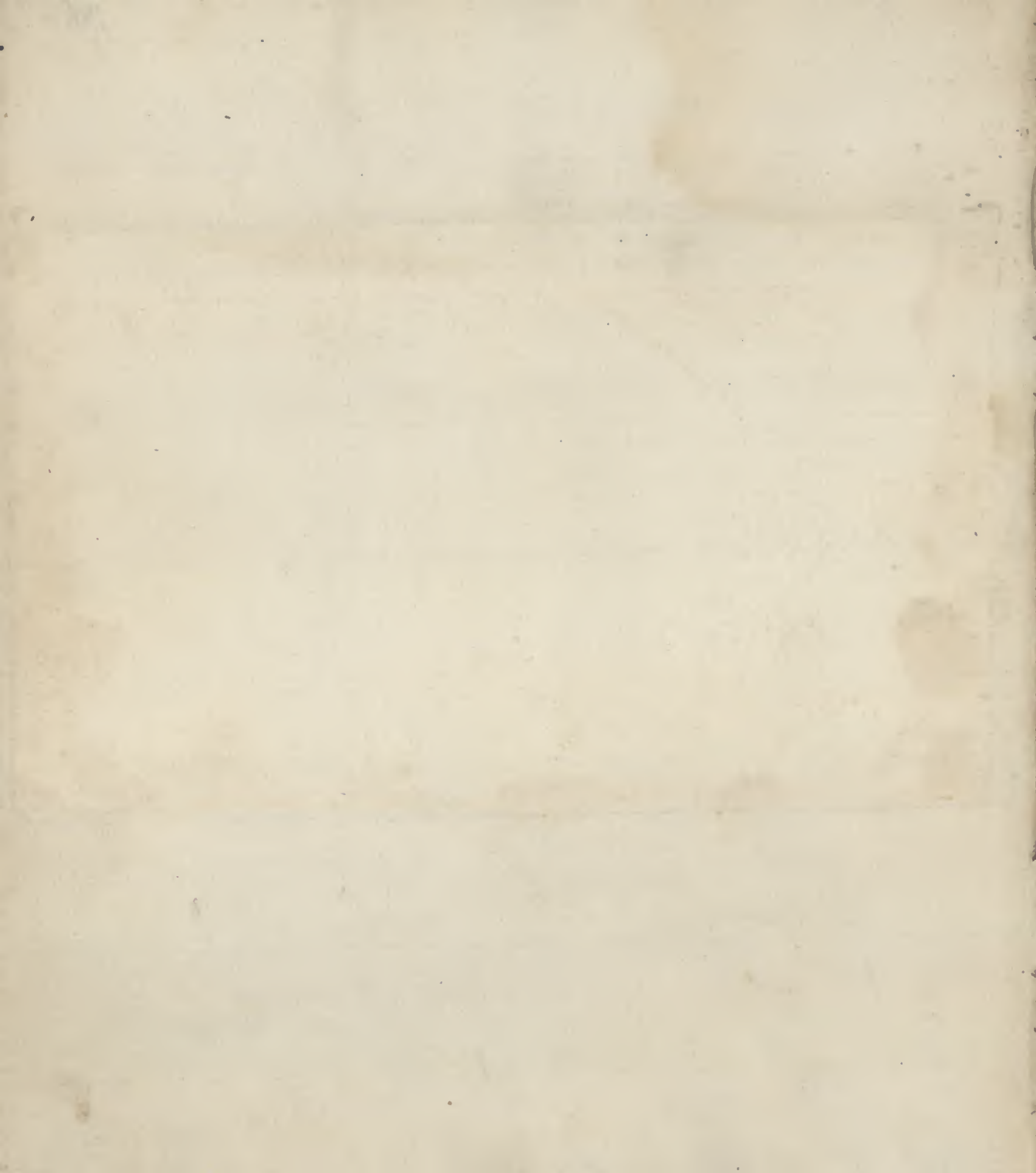





MADE IN  
ENGLAND  
BY COLLECTOR





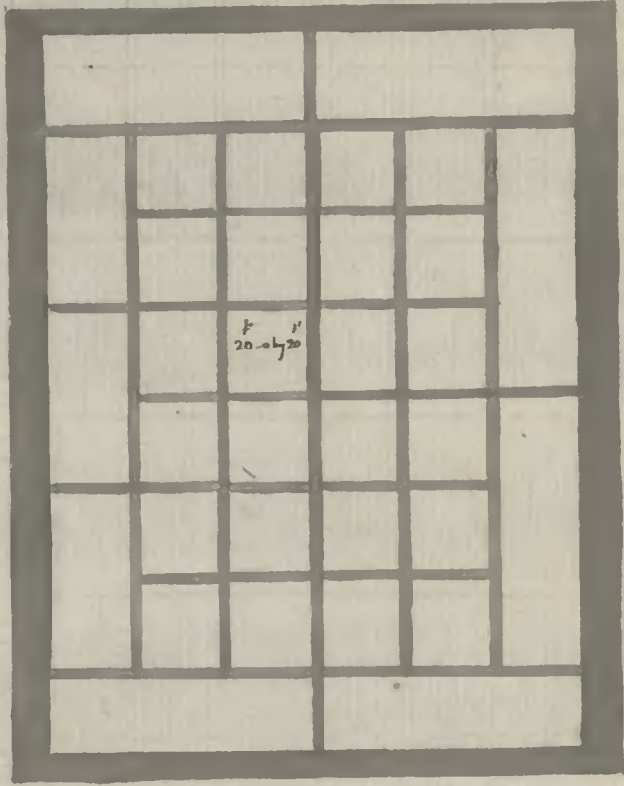

Plan of a Salt Plot as they are made at Setuwal





NATIONAL  
LIBRARY OF  
IRELAND.  
Joy Collection



D. A.  
5 V.

147

